

Automatic Date & Time Setup Instructions

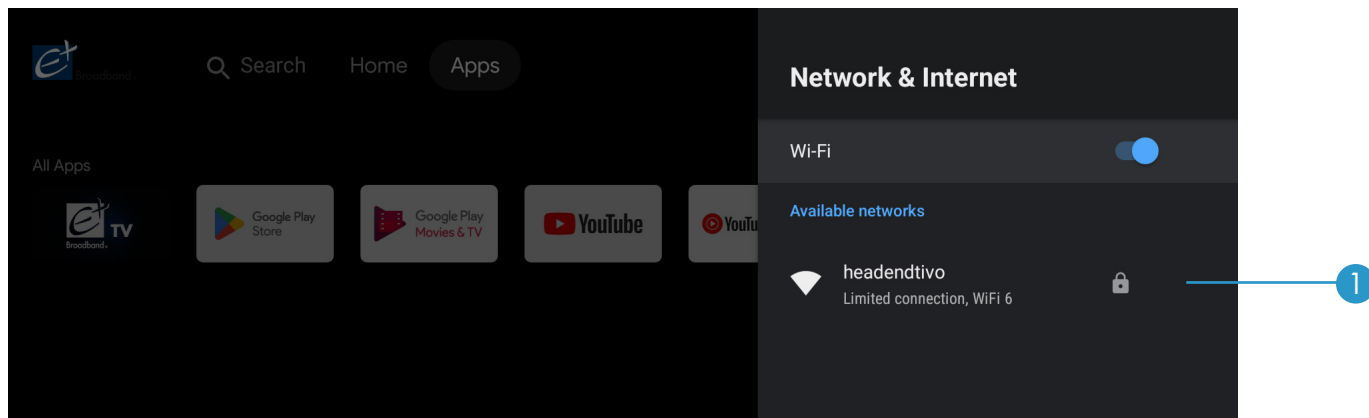

1. To set your device to record programs in the future or to watch recorded programs, you must first set the date and time on your Android TV or box to automatic. Until this is changed, your screen will show **LIMITED CONNECTION** under the WIFI network (SSID) that it is connected to. To change this, see the instructions below:

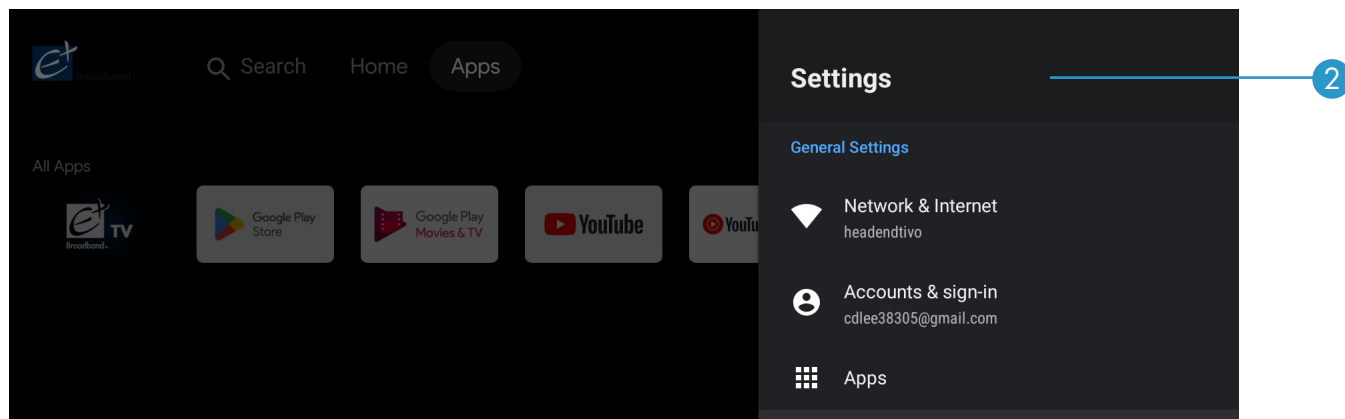

2. Go to **SETTINGS**.

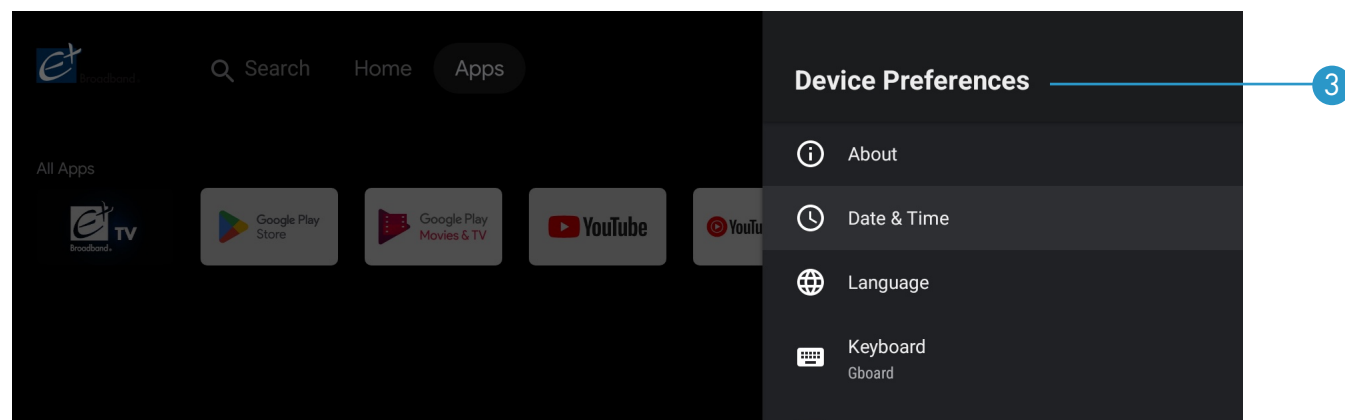

3. Select **DEVICE PREFERENCES**.

Automatic Date & Time Setup (cont'd.)

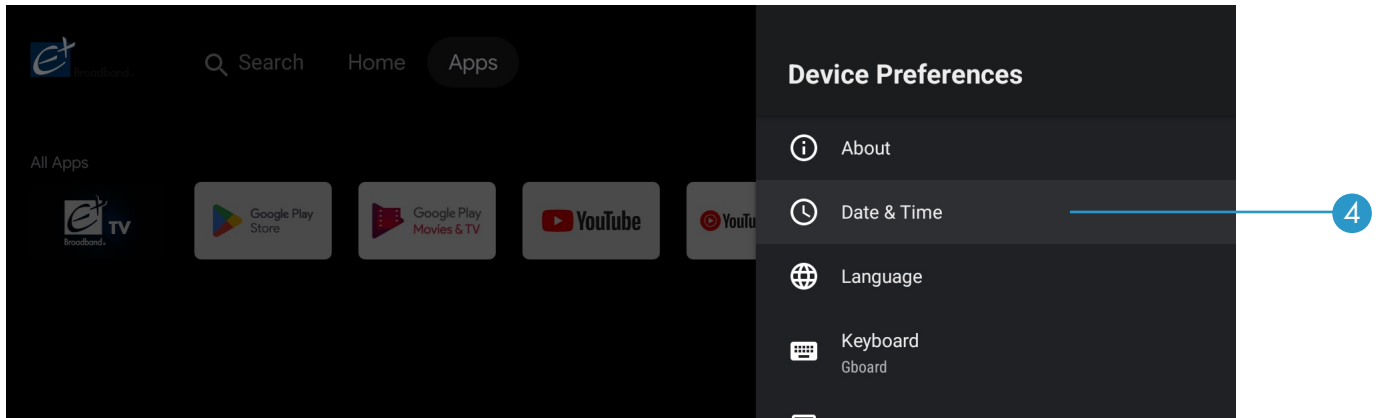

4. Select **DATE & TIME**.

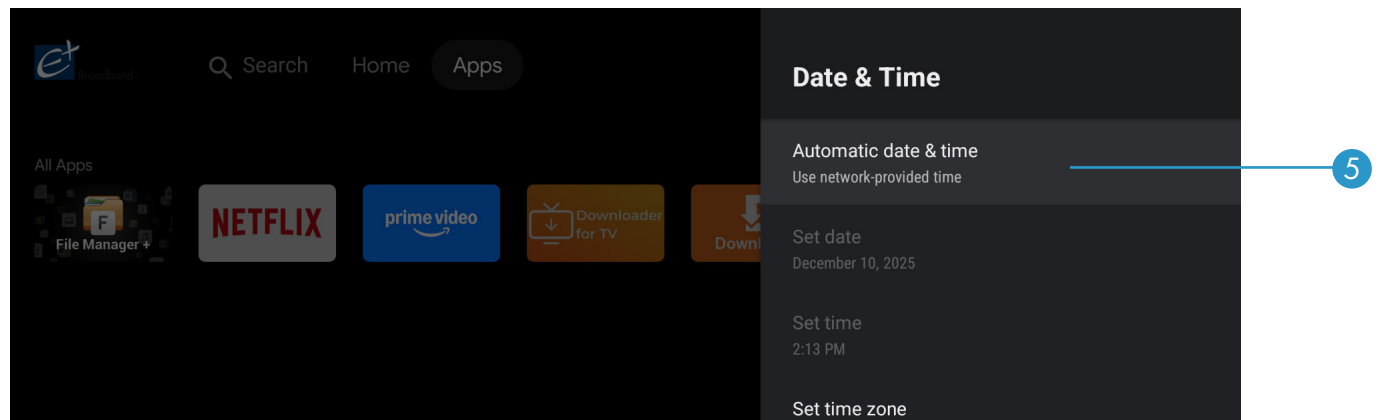

5. Under Date & Time, select **AUTOMATIC DATE & TIME**.

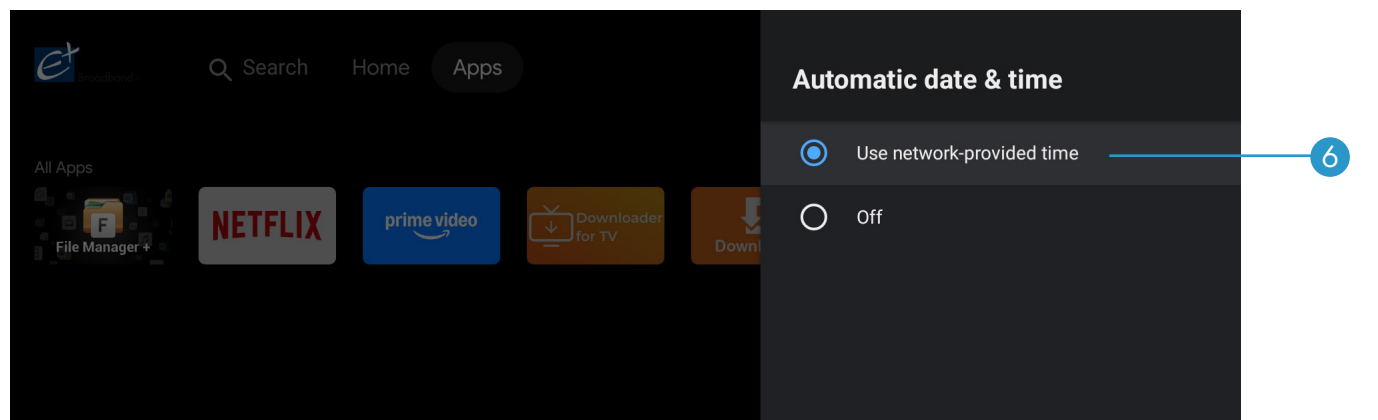

6. Upon selecting Automatic date & time, select the circle to **USE NETWORK-PROVIDED TIME**.

Automatic Date & Time Setup (cont'd.)

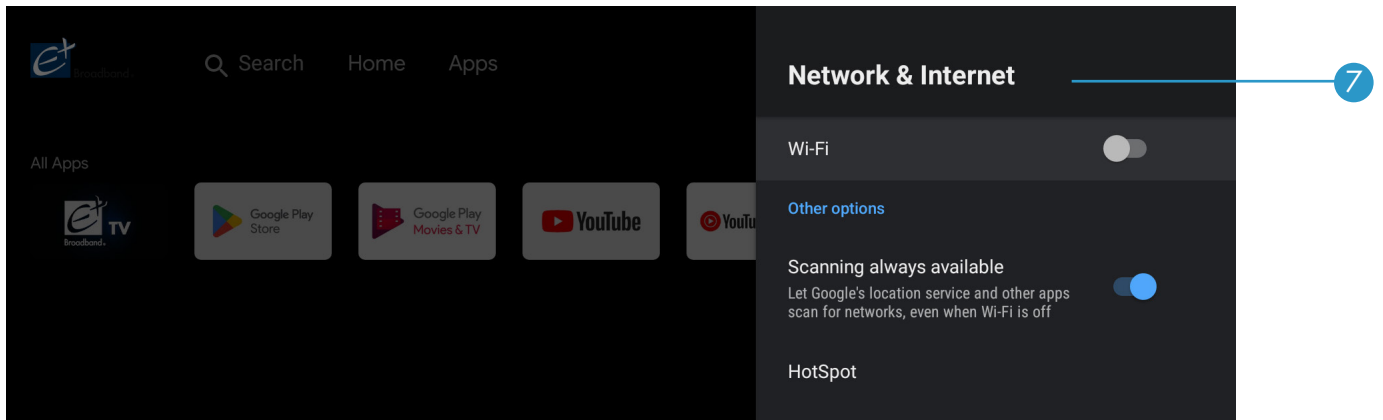

7. Return to **NETWORK & INTERNET** on the home page by hitting the back arrow on your remote.

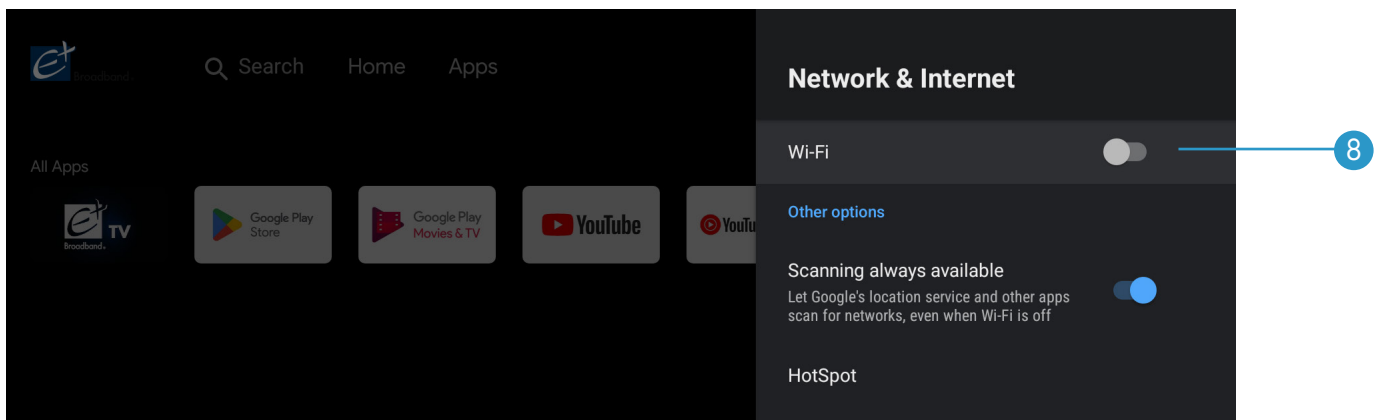

8. Disable **WiFi** by clicking the blue switch to off.

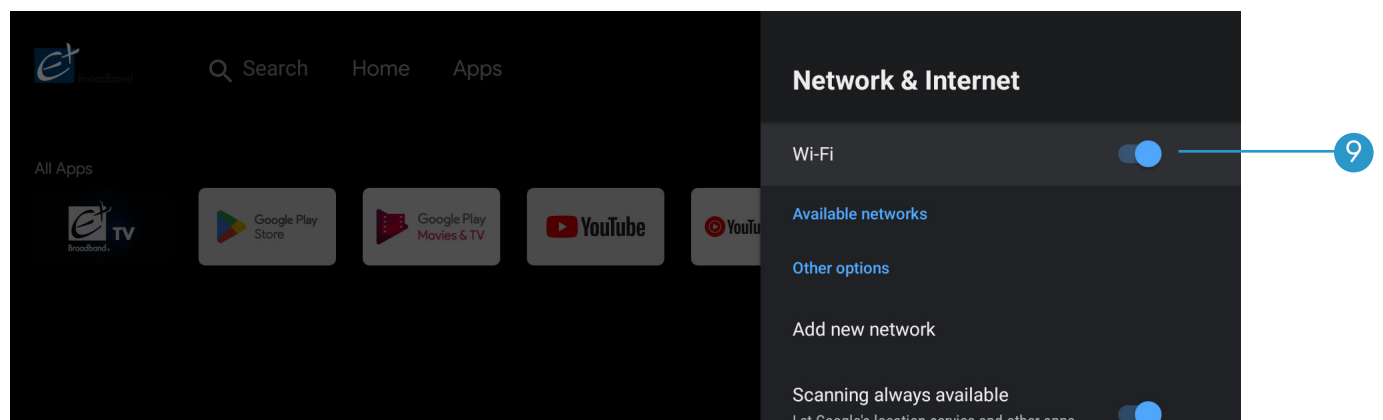

9. Enable **WiFi** by setting the blue switch to on.



Automatic Date & Time Setup (cont'd.)

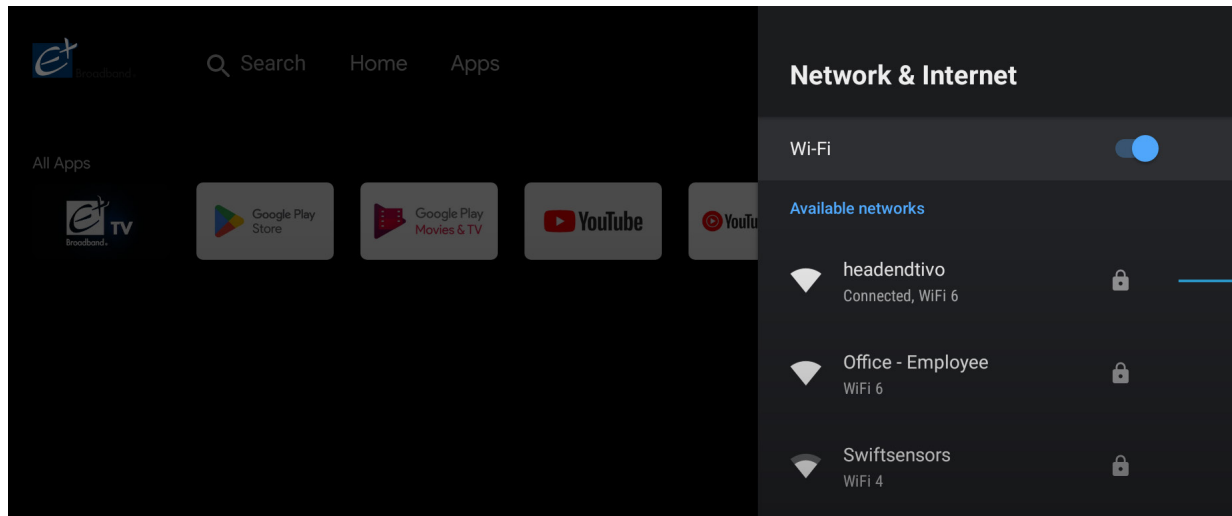

10. Your WiFi SSID should show as connected now.

If you are using these instructions because you received a **NETWORK ERROR** and your video did not play, the error should be gone and the video should play. If you are still experiencing issues call Jackson Energy Authority's Customer Service at 731.422.7500.